



Door County Coop - FILL
92 East Maple Street, Sturgeon Bay, Wisconsin
DNR BRRTS #: 02-15-544253 (formerly 09-15-544253)

Former Door County Coop - VPLE
92 East Maple Street, Sturgeon Bay, Wisconsin
DNR BRRTS #: 06-15-560738

Door County Coop
92 East Maple Street, Sturgeon Bay, Wisconsin
DNR BRRTS #: 03-15-000659

GROUND SURFACE COVER

- GRASS
- SAND & GRAVEL
- ASPHALT/CONCRETE

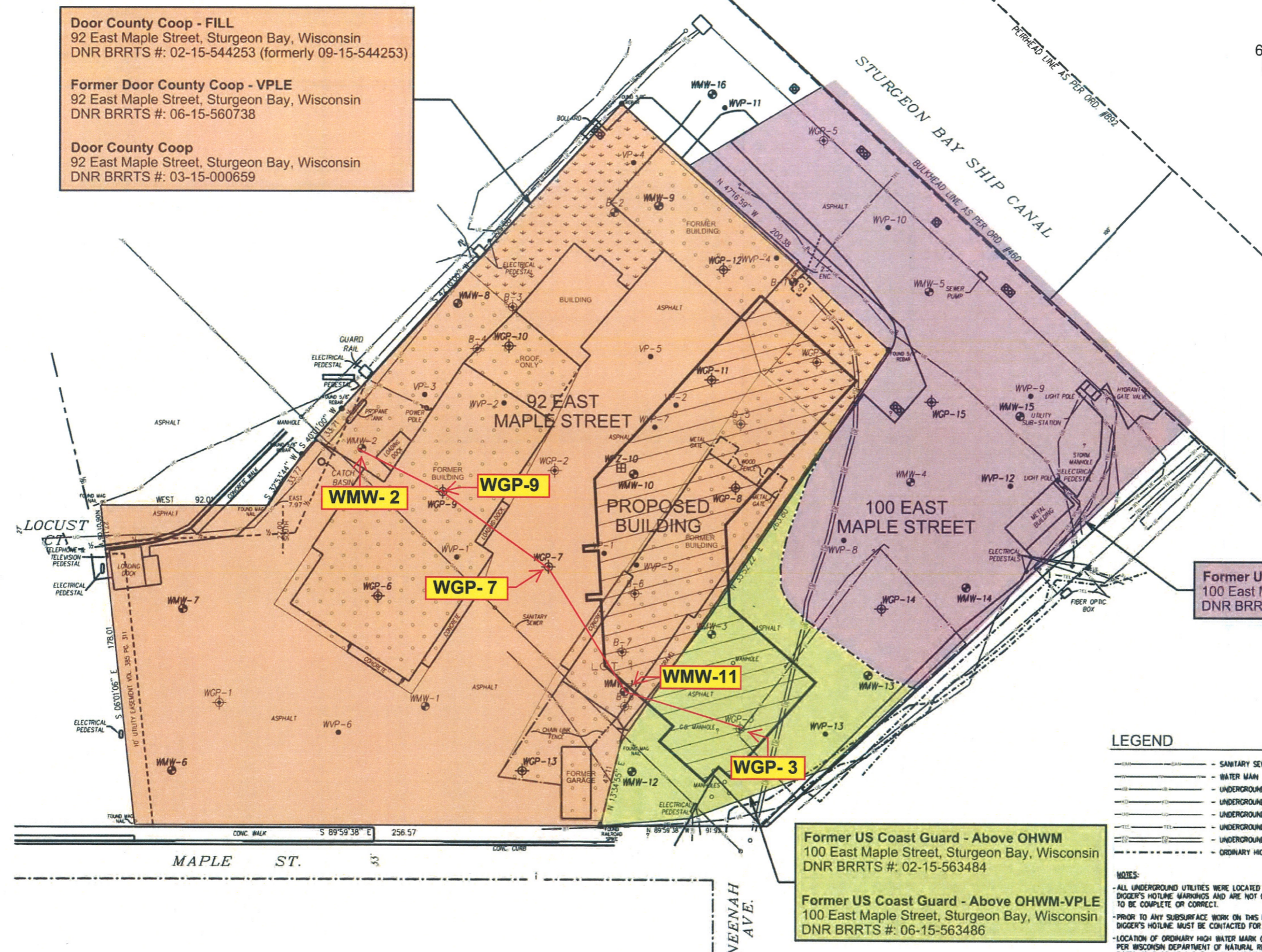

Former US Coast Guard - Below OHWM
100 East Maple Street, Sturgeon Bay, Wisconsin
DNR BRRTS #: 02-15-563485

Former US Coast Guard - Above OHWM
100 East Maple Street, Sturgeon Bay, Wisconsin
DNR BRRTS #: 02-15-563484

Former US Coast Guard - Above OHWM-VPLE
100 East Maple Street, Sturgeon Bay, Wisconsin
DNR BRRTS #: 06-15-563486

LEGEND

- SANITARY SEWER LINE
 - WATER MAIN
 - UNDERGROUND ELECTRIC LINE
 - UNDERGROUND FIBER OPTIC LINE
 - UNDERGROUND GAS LINE
 - UNDERGROUND TELEPHONE LINE
 - UNDERGROUND ELECTRIC & FIBER OPTIC
 - ORDINARY HIGH WATER MARK
 - MONITORING WELL
 - GEOPROBE
 - VAPOR PROBE
 - PIEZOMETER
 - MONITORING WELL (BY STS CONSULTANTS 2004)
 - GEOPROBE (BY STS CONSULTANTS 2004)
 - VAPOR PROBE (BY STS CONSULTANTS 2004)
- NOTES:**
- ALL UNDERGROUND UTILITIES WERE LOCATED AS PER DIGGER'S HOTLINE MARKINGS AND ARE NOT GUARANTEED TO BE COMPLETE OR CORRECT.
 - PRIOR TO ANY SUBSURFACE WORK ON THIS PROPERTY, DIGGER'S HOTLINE MUST BE CONTACTED FOR A RE-LOCATE.
 - LOCATION OF ORDINARY HIGH WATER MARK OF STURGEON BAY PER WISCONSIN DEPARTMENT OF NATURAL RESOURCES BASED ON PLAT OF SURVEY DATED OCTOBER 2, 2014

| DESIGNED BY | BOOK NO. | DATE | REVISION | NO. | DATE | REVISION |
|-------------|----------|------------|---|-----|------|----------|
| J. STEINER | 1 | 02-11-2015 | ADDED ORDINARY HIGH WATER MARK FOR STURGEON BAY | | | |
| T. SHUPERT | 2 | 06-11-2015 | ADDED WCP-13 - 15, WMW-12 - 16, WVP-11 - 13 | | | |
| J. STEINER | 3 | 09-25-2015 | ADDED GROUND SURFACE COVER INFORMATION | | | |
| J. STEINER | | JUNE 2015 | | | | |

WEST WATERFRONT REDEVELOPMENT PROJECT
CITY OF STURGEON BAY
STURGEON BAY, WISCONSIN



SITE MAP

Ayres_dft.plt
 ES_text_04d.tbl
 9/9/2015
 L:\Sturgeon Bay\OGN\Site Map w/ Prop Building.dgn

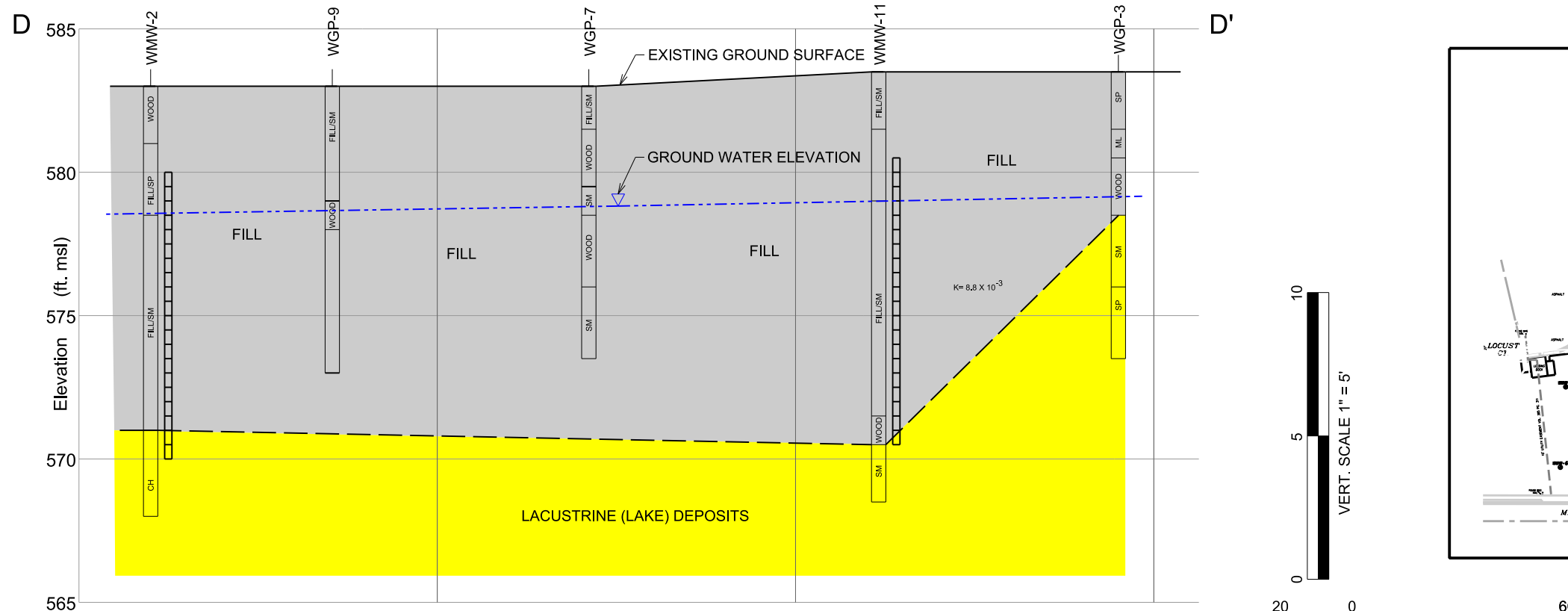

SECTION D - D'

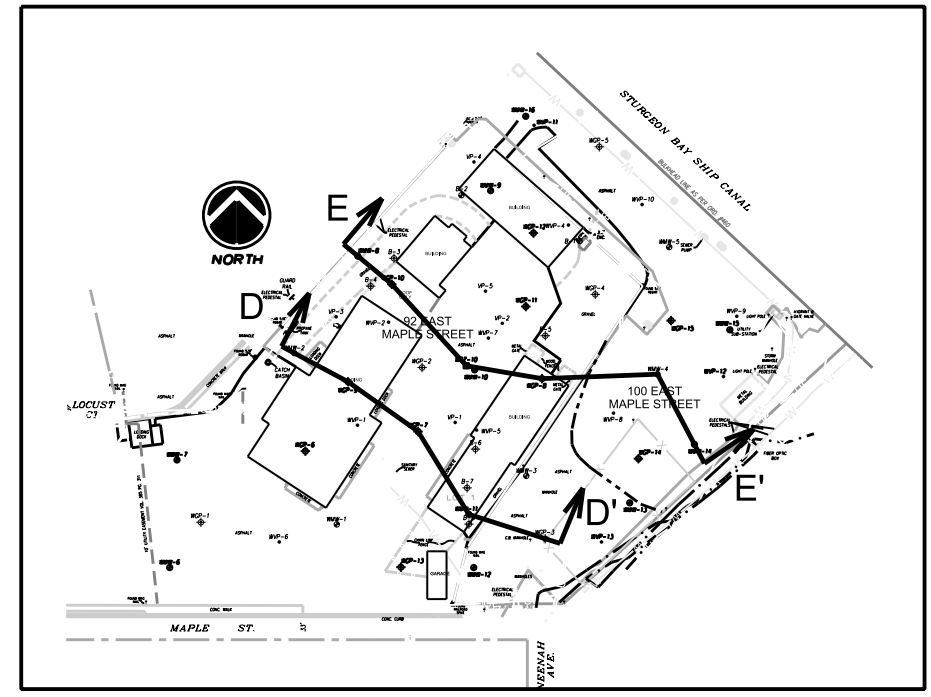

SECTION LOCATION MAP
NTS

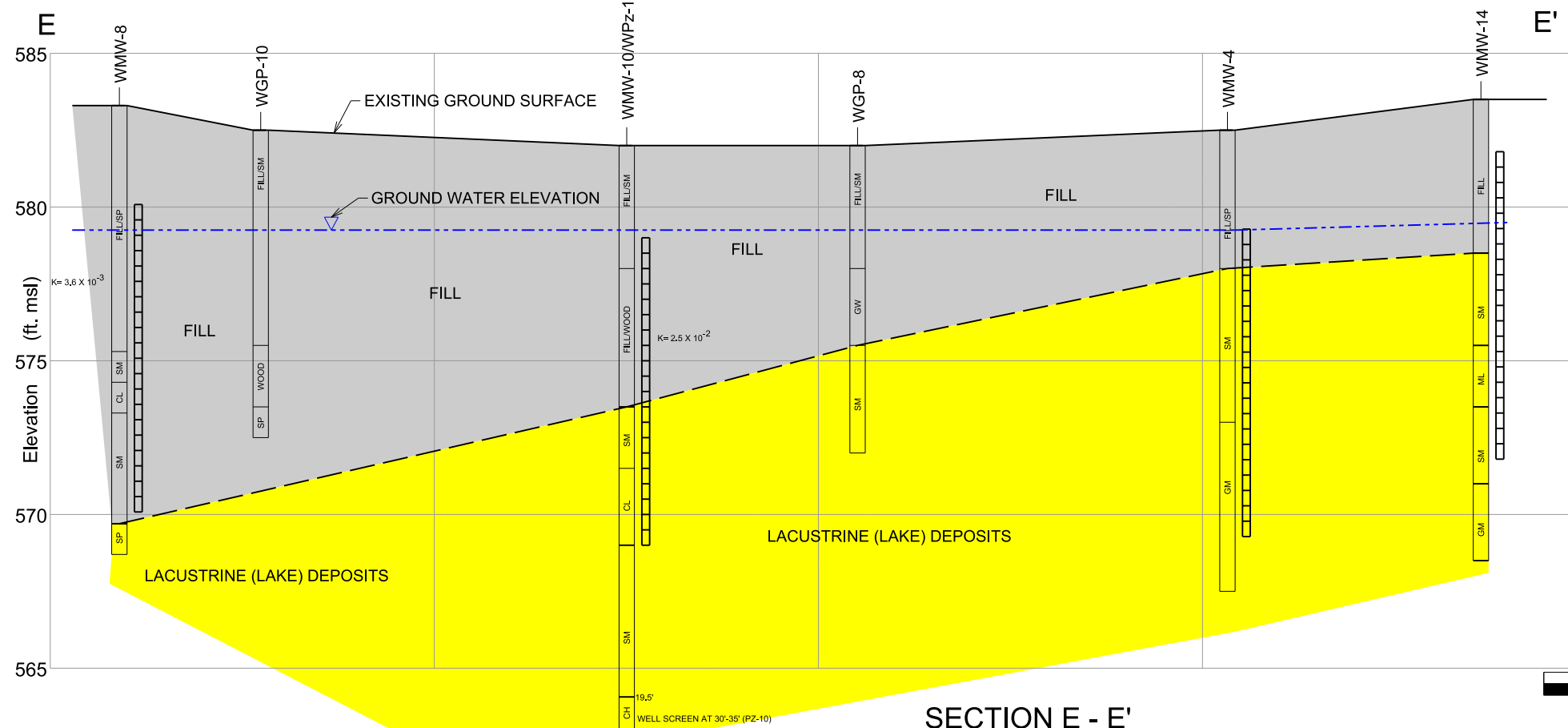
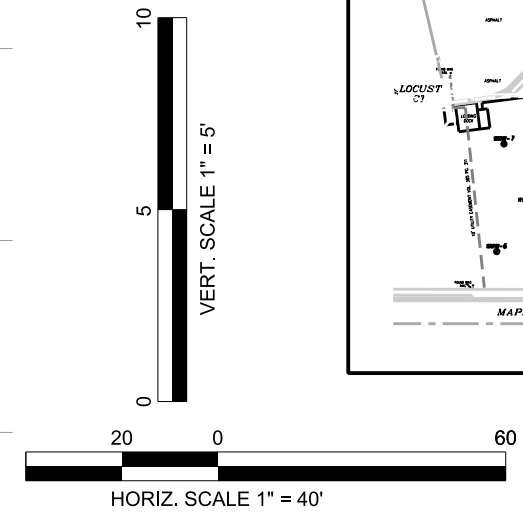

SECTION E - E'

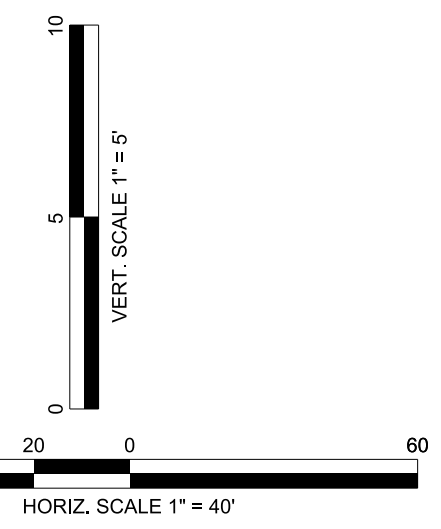

- LEGEND**
- WATER LEVEL MEASURED IN WATER TABLE OBSERVATION WELL
 - MONITORING WELL SCREEN INTERVAL
 - CL INORGANIC CLAYS OF LOW PLASTICITY
 - CH INORGANIC CLAYS OF HIGH PLASTICITY
 - ML INORGANIC SILTS AND VERY FINE SANDS OR CLAYEY SILTS WITH SLIGHT PLASTICITY
 - SC CLAYEY SANDS, SAND - CLAY MIXTURES
 - SM SILTY SANDS, SAND - SILT MIXTURES
 - SP POORLY - GRADED SANDS, GRAVELLY SANDS, LITTLE OR NO FINES
 - GM SILTY GRAVELS, GRAVEL - SAND - SILT MIXTURES
 - GP POORLY GRADED GRAVELS, GRAVEL - SAND MIXTURES, LITTLE OR NO FINES
 - $K = 4.9 \times 10^{-3}$ HYDRAULIC CONDUCTIVITY (cm/sec)

Avesa.pdf.plt
 ES: 10/23/2015
 6/23/2015
 V:\EN\CAD\Sturgeon Bay\DWG\Geologic\Sections C.dgn

| | | | |
|--------|------------|----------|------------|
| DES BY | J. STEINER | BOOK NO | |
| DR BY | T. SHUPERT | JOB NO | 19-0422.00 |
| CHK BY | J. STEINER | DATE | JUNE 2015 |
| | NO | DATE | |
| | REVISION | NO | DATE |
| | | REVISION | |

WEST WATERFRONT REDEVELOPMENT PROJECT
 CITY OF STURGEON BAY
 STURGEON BAY, WISCONSIN



GEOLOGICAL CROSS SECTION D - D' AND E - E'

DRAWING NO
6

Route to:
 Watershed/Wastewater Waste Management
 Remediation/Redevelopment Other

| | | | | | |
|---|-----------------|---------------------------|---|---|--|
| Facility/Project Name West Waterfront Redevelopment Project | | | License/Permit/Monitoring Number | | Boring Number WMW-2 |
| Boring Drilled By: Name of crew chief (first,last) and Firm First Name: Tony Last Name: Kapugi Firm: On_Site Environmental Drilling Inc. | | | Date Drilling Started 5/23/2013 M/D/Y | Date Drilling Completed 5/23/2013 M/D/Y | Drilling Method 4.25" ID Hollow Stem Auger |
| WI Unique Well No. | DNR Well Id No. | Well Name WMW-2 | Final Static Water Level 3.85 | Surface Elevation | Borehole Dia. 8-inch |
| Local Grid Origin L (estimated: <input type="checkbox"/>) or Boring Location <input type="checkbox"/> State Plane <u> </u> N, <u> </u> E NE 1/4 of NE 1/4, of Section 7, T 27 N, R 26 E | | | Lat. <u> </u> " <u> </u> " | Local Grid Location (If applicable) <input type="checkbox"/> N <input type="checkbox"/> E <input type="checkbox"/> S <input type="checkbox"/> W | |
| Facility Id. | | County Door | County Code 15 | Civil Town/City/or Village City of Sturgeon Bay | |

| SAMPLE | | | | SOIL/ROCK DESCRIPTION AND GEOLOGIC ORIGIN FOR EACH MAJOR UNIT | USCS | Graphic Log | Well Diagram | PID/FID | SOIL PROPERTIES | | | | | RQD/Comments |
|-----------------|-------------------------------|-------------|--------------------------------------|--|---------------|-------------|--------------|---------|----------------------|------------------|--------------|------------------|-------|--------------|
| Number and Type | Length, Alt. & Recovered (ft) | Blow Counts | Depth in feet (Below ground surface) | | | | | | Compressive Strength | Moisture Content | Liquid Limit | Plasticity Index | P-200 | |
| | | | -1 | Topsoil (2") FILL, Wood, moist, | FILL/ Wood | | | 0 | | M | | | | |
| | | | -2 | | | | | | | | | | | |
| | | | -3 | FILL, SAND, silty, some gravel and cobbles, fine, grained, no odor, brown | FILL/ SP | | | 0 | | D | | | | |
| | | | -4 | | | | | | | | | | | |
| | | | -5 | FILL, WOOD, at 5 feet | FILL/ Wood | | | 0 | | M | | | | |
| | | | -6 | FILL, SAND, silty, some gravel, wet, fine grained, no odor, brown | FILL/ Wood | | | 0 | | M | | | | |
| | | | -7 | wood at 6-7 feet | | | | 0 | | W | | | | |
| | | | -8 | black to gray sand | SM | | | 0 | | W | | | | |
| | | | -9 | | | | | | | | | | | |
| | | | -10 | | | | | | | | | | | |
| | | | -11 | organics, wood chips, soft, black 11-12 feet, some small shells | SM | | | 0 | | W | | | | |
| | | | -12 | | | | | | | | | | | |
| | | | -13 | CLAY, silty, very stiff, wet, high plasticity, no odor, red | CH | | | 0 | | W | | | | |
| | | | -14 | | | | | | | | | | | |
| | | | -15 | | | | | | | | | | | |
| | | | -16 | EOB @ 15 feet bgs Well set @ 12.8 feet | | | | | | | | | | |
| | | | -17 | | | | | | | | | | | |
| | | | -18 | | | | | | | | | | | |
| | | | -19 | | | | | | | | | | | |
| | | | -20 | | | | | | | | | | | |
| | | | -21 | | | | | | | | | | | |
| | | | -22 | | | | | | | | | | | |
| | | | -23 | | | | | | | | | | | |
| | | | -24 | | | | | | | | | | | |
| | | | -25 | | | | | | | | | | | |

I hereby certify that the information on this form is true and correct to the best of my knowledge.

Signature Firm **AYRES ASSOCIATES**

This form is authorized by Chapters 281, 283, 289, 291, 292, 293, 295, and 299, Wis.Stats. Completion of this report is mandatory. Failure to file this form may result in forfeiture of between \$10 and \$25,000, or imprisonment for up to one year, depending on the program and conduct involved. Personally identifiable information on this form is not intended to be used for any other purpose. NOTE: See instructions for more information, including where the completed form should be sent.

Route to:
 Watershed/Wastewater Waste Management
 Remediation/Redevelopment Other

| Facility/Project Name West Waterfront Redevelopment Project | | | | License/Permit/Monitoring Number | | | | Boring Number WGP-9 | | | | | | | | |
|--|------------------------------|-----------------------|-------------|---|---|---|-------------|------------------------------------|---------|--------------------------------|--------------|------------------|-------|--|--------------|--|
| Boring Drilled By: Name of crew chief (first,last) and Firm First Name: Tony Last Name: Kapugi Firm: On Site Environmental Drilling Inc. | | | | Date Drilling Started 7/15/2014 M/D/Y | | Date Drilling Completed 7/15/2014 M/D/Y | | Drilling Method Geoprobe | | | | | | | | |
| WI Unique Well No. | | DNR Well Id No. | | Well Name WGP-9 | | Final Static Water Level | | Surface Elevation | | Borehole Dia. 2-inch | | | | | | |
| Local Grid Origin (estimated: <input type="checkbox"/>) or Boring Location <input type="checkbox"/> State Plane N , E NE 1/4 of NE 1/4, of Section 7, T 27 N, R 26 E | | | | Lat. " ' " | | Local Grid Location (If applicable) <input type="checkbox"/> N <input type="checkbox"/> E <input type="checkbox"/> S <input type="checkbox"/> W | | Feet | | Feet | | | | | | |
| Facility Id. | | County Door | | County Code 15 | | Civil Town/City/or Village City of Sturgeon Bay | | | | | | | | | | |
| SAMPLE | | | Blow Counts | Depth in Feet (Below ground surface) | SOIL/ROCK DESCRIPTION AND GEOLOGIC ORIGIN FOR EACH MAJOR UNIT | USCS | Graphic Log | Well Diagram | PID/FID | SOIL PROPERTIES | | | | | RQD/Comments | |
| Number and Type | Length Att. & Recovered (in) | Moisture Content | | | | | | | | Compressive Strength | Liquid Limit | Plasticity Index | P 200 | | | |
| | | | | -1 | Concrete (4") FILL, SAND, some silt, some gravel, moist no odor, lt gray - lt brown | FILL/ SM | | | 0 | | | | | | | |
| | | | | -4 | | | | | 0 | | | | | | | |
| | | | | -5 | FILL, Wood, some plastic, moist, no odor dk brown | Wood | | | | | | | | | | |
| | | | | -6 | FILL, SAND, some silt, some gravel, moist, no odor, gray | SM | | | 0 | | | | | | | |
| | | | | -10 | | | | | 0 | | | | | | | |
| | | | | -11 | EOB @ 10 feet bgs Abandoned with bentonite chips | | | | | | | | | | | |

I hereby certify that the information on this form is true and correct to the best of my knowledge.

Signature *[Handwritten Signature]* Firm **AYRES ASSOCIATES**

This form is authorized by Chapters 281, 283, 289, 291, 292, 293, 295, and 299, Wis. Stats. Completion of this report is mandatory. Failure to file this form may result in forfeiture of between \$10 and \$25,000, or imprisonment for up to one year, depending on the program and conduct involved. Personally identifiable information on this form is not intended to be used for any other purpose. NOTE: See instructions for more information, including where the completed form should be sent.

Route to:
 Watershed/Wastewater Waste Management
 Remediation/Redevelopment Other

| | | | | | |
|--|-----------------------|---------------------------|---|---|------------------------------------|
| Facility/Project Name West Waterfront Redevelopment Project | | | License/Permit/Monitoring Number | | Boring Number WGP-7 |
| Boring Drilled By: Name of crew chief (first,last) and Firm First Name: Tony Last Name: Kapugi Firm: On Site Environmental Drilling Inc. | | | Date Drilling Started 7/15/2014 M/D/Y | Date Drilling Completed 7/15/2014 M/D/Y | Drilling Method Geoprobe |
| WI Unique Well No. | DNR Well Id No. | Well Name WGP-7 | Final Static Water Level | Surface Elevation | Borehole Dia. 2-inch |
| Local Grid Origin L (estimated: <input type="checkbox"/>) or Boring Location <input type="checkbox"/> State Plane N , E NE 1/4 of NE 1/4, of Section 7, T 27 N, R 26 E | | | Lat. " ' " | Local Grid Location (If applicable) <input type="checkbox"/> N <input type="checkbox"/> E <input type="checkbox"/> S <input type="checkbox"/> W | |
| Facility Id. | County Door | County Code 15 | Civil Town/City/or Village City of Sturgeon Bay | | |

| SAMPLE | | Blow Counts | Depth in Feet (Below ground surface) | SOIL/ROCK DESCRIPTION AND GEOLOGIC ORIGIN FOR EACH MAJOR UNIT | USCS | Graphic Log | Well Diagram | PID/FID | SOIL PROPERTIES | | | | | RQC/Comments | | | |
|-----------------|-------------------------------|-------------|--------------------------------------|---|---------------|-------------|--------------|---------|----------------------|------------------|--------------|------------------|-------|--------------|--|--|--|
| Number and Type | Length, Alt. & Recovered (in) | | | | | | | | Compressive Strength | Moisture Content | Liquid Limit | Plasticity Index | P 200 | | | | |
| | | | -1 | Concrete (4") FILL, SAND, some silt, some gravel, moist no odor, lt brown | FILL/ SM | | | 0 | | | | | | | | | |
| | | | -2 | FILL, woodchips, moist, no odor, black | Fill/ Wood | | | | | | | | | | | | |
| | | | -3 | | | | | | | | | | | | | | |
| | | | -4 | FILL, SAND, some silt, some gravel, moist, n dk brown/black | SM | | | 0 | | | | | | | | | |
| | | | -5 | FILL, Wood, some gravel, moist, no odor lt brown - dk brown | FILL/ Wood | | | | | | | | | | | | |
| | | | -6 | | | | | | | | | | | | | | |
| | | | -7 | SAND, some silt, wet, no odor, dk gray | SM | | | 0 | | | | | | | | | |
| | | | -8 | | | | | | | | | | | | | | |
| | | | -9 | | | | | | | | | | | | | | |
| | | | -10 | | | | | 0 | | | | | | | | | |
| | | | -11 | EOB @ 10 feet bgs Abandoned with bentonite chips | | | | | | | | | | | | | |
| | | | -12 | | | | | | | | | | | | | | |
| | | | -13 | | | | | | | | | | | | | | |
| | | | -14 | | | | | | | | | | | | | | |
| | | | -15 | | | | | | | | | | | | | | |
| | | | -16 | | | | | | | | | | | | | | |
| | | | -17 | | | | | | | | | | | | | | |
| | | | -18 | | | | | | | | | | | | | | |
| | | | -19 | | | | | | | | | | | | | | |
| | | | -20 | | | | | | | | | | | | | | |
| | | | -21 | | | | | | | | | | | | | | |
| | | | -22 | | | | | | | | | | | | | | |
| | | | -23 | | | | | | | | | | | | | | |
| | | | -24 | | | | | | | | | | | | | | |
| | | | -25 | | | | | | | | | | | | | | |

I hereby certify that the information on this form is true and correct to the best of my knowledge.
 Signature Firm **AYRES ASSOCIATES**

This form is authorized by Chapters 281, 283, 289, 291, 292, 293, 295, and 299, Wis. Stats. Completion of this report is mandatory. Failure to file this form may result in forfeiture of between \$10 and \$25,000, or imprisonment for up to one year, depending on the program and conduct involved. Personally identifiable information on this form is not intended to be used for any other purpose. NOTE: See instructions for more information, including where the completed form should be sent.

Route to:
 Watershed/Wastewater Waste Management
 Remediation/Redevelopment Other

| | | | | | |
|---|-----------------|----------------------------|---|---|--|
| Facility/Project Name West Waterfront Redevelopment Project | | | License/Permit/Monitoring Number: | | Boring Number WMW-11 |
| Boring Drilled By: Name of crew chief (first,last) and Firm First Name: Tony Last Name: Kapugi Firm: On_Site Environmental Drilling Inc. | | | Date Drilling Started 7/15/2014 M/D/Y | Date Drilling Completed 7/15/2014 M/D/Y | Drilling Method 4.25" ID Hollow Stem Auger |
| WI Unique Well No. | DNR Well Id No. | Well Name WMW-11 | Final Static Water Level 3.81 | Surface Elevation 583.5 | Borehole Dia. 8-inch |
| Local Grid Origin (estimated: <input type="checkbox"/>) or Boring Location <input type="checkbox"/> State Plane _____ N, _____ E NE 1/4 of NE 1/4, of Section 7, T 27 N, R 26 E | | | Lat. _____ | Local Grid Location (If applicable) <input type="checkbox"/> N <input type="checkbox"/> E <input type="checkbox"/> S <input type="checkbox"/> W | |
| Facility Id. | | County Door | County Code 15 | Civil Town/City/or Village City of Sturgeon Bay | |

| SAMPLE | | Blow Counts | Depth in Feet (Below ground surface) | SOIL/ROCK DESCRIPTION AND GEOLOGIC ORIGIN FOR EACH MAJOR UNIT | USCS | Graphic Log | Well Diagram | PID/FID | SOIL PROPERTIES | | | | | ROD/Comments |
|-----------------|------------------------------|-------------|--------------------------------------|---|-------------|-------------|--------------|---------|----------------------|------------------|--------------|------------------|-------|--------------|
| Number and Type | Length Att. & Recovered (in) | | | | | | | | Compressive Strength | Moisture Content | Liquid Limit | Plasticity Index | P-200 | |
| | | | -1 | Gravel Lot (4") FILL, SAND, some silt, some gravel, moist no odor, gray/brown/red | FILL/ SM | | | 0 | | M | | | | |
| | | | -2 | NO RECOVERY, 2.5 - 5.0 ft | | | | 0 | | W | | | | |
| | | | -5 | Fill, SAND, some silt, some gravel, wet, no odor, red/brown | SM | | | 0 | | W | | | | |
| | | | -9 | **Some organics and odor @ 9.5 ft | | | | 0 | | W | | | | |
| | | | -13 | FILL, some woodchips, moist, no odor dk brown | PT | | | 0 | | W | | | | |
| | | | -14 | SAND, some silt, some gravel, wet, no odor, gray/brown | SM | | | 0 | | W | | | | |
| | | | -16 | EOB @ 15 feet bgs Well set @ 12.7 feet | | | | | | | | | | |

I hereby certify that the information on this form is true and correct to the best of my knowledge.
 Signature: *Jeff Stearn* Firm: **AYRES ASSOCIATES**

This form is authorized by Chapters 281, 283, 289, 291, 292, 293, 295, and 299, Wis.Stats. Completion of this report is mandatory. Failure to file this form may result in forfeiture of between \$10 and \$25,000, or imprisonment for up to one year, depending on the program and conduct involved. Personally identifiable information on this form is not intended to be used for any other purpose. NOTE: See instructions for more information, including where the completed form should be sent.

Route to:
 Watershed/Wastewater Waste Management
 Remediation/Redevelopment Other

| Facility/Project Name West Waterfront Redevelopment Project | | | | License/Permit/Monitoring Number | | | | Boring Number WGP-3 | | | | | | |
|---|------------------------------|-----------------------|--------------------------------------|--|---------|---|--------------|------------------------------------|----------------------|--------------------------------|--------------|------------------|-------|--------------|
| Boring Drilled By: Name of crew chief (first,last) and Firm First Name: Tony Last Name: Kapugi Firm: On_Site Environmental Drilling Inc. | | | | Date Drilling Started 5/23/2013 M/D/Y | | Date Drilling Completed 5/23/2013 M/D/Y | | Drilling Method Geoprobe | | | | | | |
| WI Unique Well No. | | DNR Well Id No. | | Well Name | | Final Static Water Level | | Surface Elevation | | Borehole Dia. 2-inch | | | | |
| Local Grid Origin L (estimated) <input type="checkbox"/> or Boring Location <input type="checkbox"/> State Plane _____ N, _____ E NE 1/4 of NE 1/4, of Section 7, T 27 N, R 26 E | | | | Lat. _____ " _____ " | | Local Grid Location (If applicable) <input type="checkbox"/> N <input type="checkbox"/> E <input type="checkbox"/> S <input type="checkbox"/> W | | | | | | | | |
| Facility Id. | | County Door | | County Code 15 | | Civil Town/City/or Village City of Sturgeon Bay | | | | | | | | |
| SAMPLE | | SOIL PROPERTIES | | | | | | | | | | | | |
| Number and Type | Length Att. & Recovered (ft) | Blow Counts | Depth in feet (Below ground surface) | SOIL/ROCK DESCRIPTION AND GEOLOGIC ORIGIN FOR EACH MAJOR UNIT | USCS | Graphic Log | Well Diagram | PID/FID | Compressive Strength | Moisture Content | Liquid Limit | Plasticity Index | P-200 | RQD/Comments |
| | | | -1 | Asphalt (4") FILL, SAND, some gravel, trace silt, dry, medium grained, no odor, brown | FILL/SP | | | 0 | | D | | | | |
| | | | -2 | FILL, SILT, some fine sand, moist, no odor, black to brown | FILL/ML | | | | | | | | | |
| | | | -3 | | | | | | | | | | | |
| | | | -4 | Fill, Concrete | FILL | | | 0 | | M | | | | |
| | | | -5 | | | | | | | | | | | |
| | | | -6 | SAND, silty, wet, medium grained, no odor, brown | SM | | | 0.2 | | W | | | | |
| | | | -7 | some organics at 7 feet, no odor, black | | | | | | | | | | |
| | | | -8 | SAND, trace silt, wet, very fine grained, no odor, gray | SP | | | 0 | | W | | | | |
| | | | -9 | | | | | | | | | | | |
| | | | -10 | | | | | | | | | | | |
| | | | -11 | EOB @ 10 feet bgs Abandoned with bentonite chips | | | | | | | | | | |
| | | | -12 | | | | | | | | | | | |
| | | | -13 | | | | | | | | | | | |
| | | | -14 | | | | | | | | | | | |
| | | | -15 | | | | | | | | | | | |
| | | | -16 | | | | | | | | | | | |
| | | | -17 | | | | | | | | | | | |
| | | | -18 | | | | | | | | | | | |
| | | | -19 | | | | | | | | | | | |
| | | | -20 | | | | | | | | | | | |
| | | | -21 | | | | | | | | | | | |
| | | | -22 | | | | | | | | | | | |
| | | | -23 | | | | | | | | | | | |
| | | | -24 | | | | | | | | | | | |
| | | | -25 | | | | | | | | | | | |

I hereby certify that the information on this form is true and correct to the best of my knowledge.

Signature Firm **AYRES ASSOCIATES**

This form is authorized by Chapters 281, 283, 289, 291, 292, 293, 295, and 299, Wis.Stats. Completion of this report is mandatory. Failure to file this form may result in forfeiture of between \$10 and \$25,000, or imprisonment for up to one year, depending on the program and conduct involved. Personally identifiable information on this form is not intended to be used for any other purpose. NOTE: See instructions for more information, including where the completed form should be sent.