

HIGHWAY BRIDGE
S 55°-43'W

EXHIBIT
20

SHORE LINE S47°-32'E 781.3'

CITY

V.P.S. CO.
361.5'

292.85'
118°-134'-30"

MAPLE

OAK ST.

29°

PINE ST.

NEENAH AVE.

NORA JACOBS

FRED KLUTH

MEANDER LINE

SUBD. 76

BUSHMAN DOCK & TERMINAL

BUSHMAN DOCK & TERMINAL

V.M. BUSHMAN

S 4°-30' E

PROPOSED CAR-FERRY SLIP

REDWOOD ST.

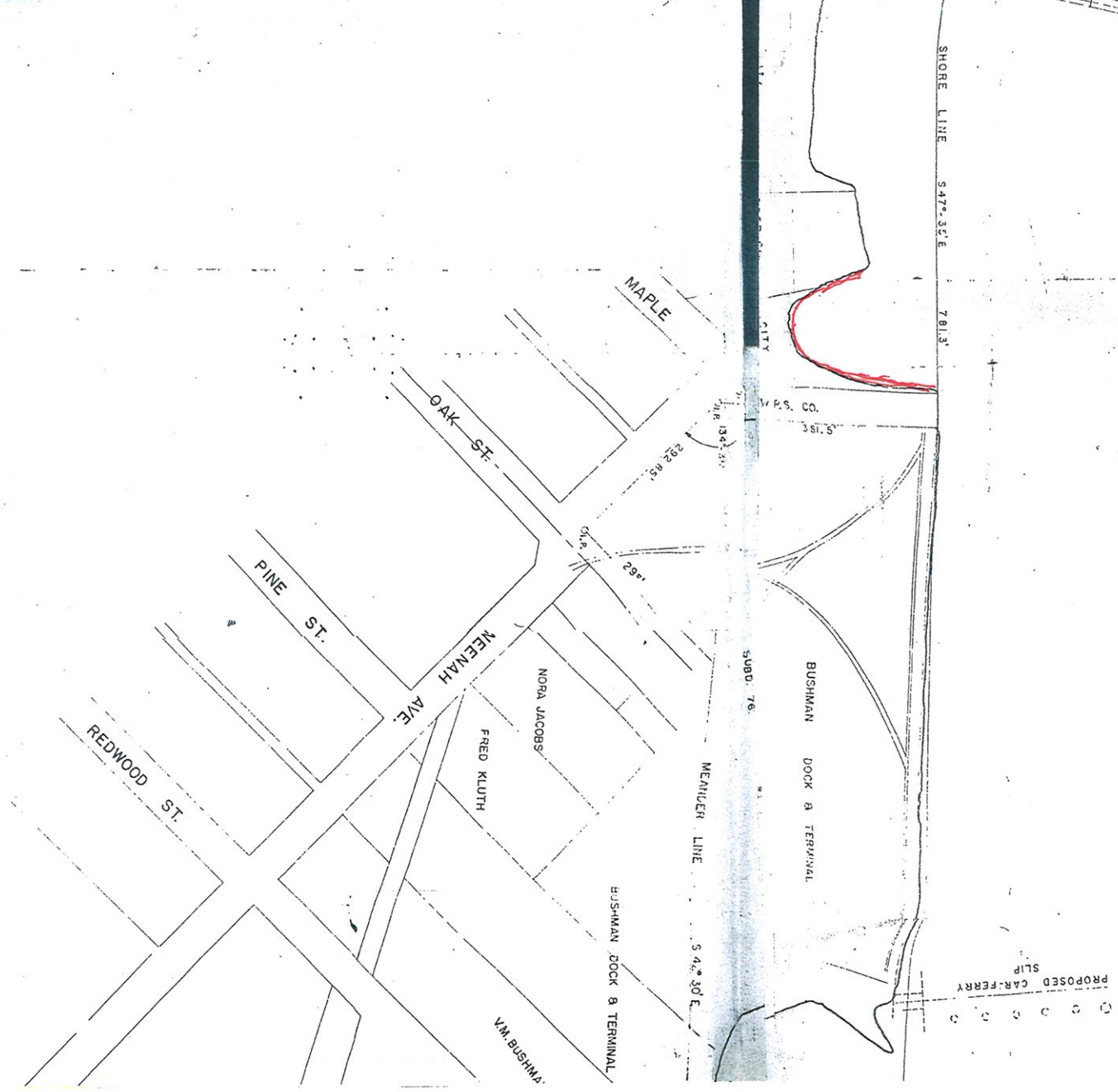

435'

PUBLIC SERVICE COMMISSION OF WISCONSIN

COMPANY CITY OF STURGEON BAY

TITLE SHORE LINE

DATE ON PLANS DEC. 6, 1955 NUMBER IN SET 1

DISTRICT Pt. of So. SHORELINE

AS EST. BY ORDINANCE NO. 460

ORIGINAL (Gr. Com. / Publ. Serv. (Company))
 EXAMINED AND FOUND CORRECT

AS PER SECTION _____ WISCONSIN STATUTES
 CHAPTER 30 LAWS OF WIS.

BY Arthur Sogler 12/19/55
 DATE

RECOMMENDED BY Warren Cahoy 12/19/55
 DATE

APPROVED BY THE
 PUBLIC SERVICE COMMISSION OF WISCONSIN

OFF: Dec. 22 - 1955
 DATE

Edward P. Kaveny
 SECRETARY

D-305.4

MAP SHOWING SHORE LINE

ON A PORTION OF THE SHORES OF STURGEON BAY, WITHIN THE CITY OF STURGEON BAY, WIS.

ESTABLISHED BY ORDINANCE NO. 460 , AS ADOPTED BY THE COMMON COUNCIL DEC. 6, 1955

SCALE: - 1" = 100' OCTOBER, 1955

JERRY SLAVIK CITY ENGINEER